



Mayra Yachts is an internationally focused yacht building company that constantly invests in the future.

We cover the entire process from the first draft to the launch to create the highest standards of mega yacht construction and design. The luxury Mayra motor yacht brings together the best of survival. Superior product quality levels, renowned design, professional engineering, meticulous attention to detail and a perfect finish.



50m S/Y ERITAN

KETCH

MONOHULL

TL1A5

DESIGNED BY PAOLO SCANU & KARATAS YD

BUILDER: MAYRA YACHTS

LEAD TIME: 16 MONTHS

## Specifications

Builder	MAYRA YACHTS
Length (LOA)	164' 5" (50,15m)
Year	2025
Gross Tonn.	272
Draft(max)	3.60
Beam	8.72
Range	TBA
Location	Turkey
Classification	TURK LOYDU 1A5

## Accommodations

Staterooms	6
Twin Cabins	3
Sleeps	12
Heads	6
Crew Cabins	3+1
Crew Sleeps	6+1
Crew Mess	1

## Dimensions & Capacity

LOA	164' 5" (50.15m)
LWL	118' 4" (36.10m)
Min Draft	7' (2.16m)
Max Draft	11' 8" (3.60m)
Fuel Tank	11,644 t (13,862 L)
Fresh Water	(5,730 L)
Gross Tonn.	272
Displacement	250t @full load

## Construction

Hull Material	Wooden with Epoxy Cov.
Ext. Designer	Studio Scanu & Karatas YD
Int. Designer	Mayra Yacht
Max Speed	15 Knots
Cruising Speed	13 Knots
Range	TBA

## Description Of The Yacht

---

50m Mayra S/Y Eritan...

She is the perfect blend of traditional sailing and modern technology - the comfort of a motor yacht combined with the thrill of sails.

Eritan is a luxury, performance cruising ketch, designed by Studio Scanu and Karataş Yacht Design with classic lines offering a clean, classic feel to a contemporary interior by Mayra Yachts.

A yacht capable of cruising the world's oceans in utmost comfort, safety, and style. The maindeck is tailored for unforgettable social gatherings, providing an exquisite setting for panoramic views.

With its vast sunbed area, convertible dining table for 16 persons, large lounge sofas, fully equipped wet-bar station; it is the perfect place for evening soirees or afternoon relaxation. Additionally, foredeck has a large sofa and coffee table.

Foldable Gangway, boarding ladder and hydraulic passarelle located at aft.

Moreover, 2x 3ManJetski and 1x Tender boat are located for amazing times and service on the forward side.



## **S/Y ERITAN - Highlights**

TL Certification

Designed and engineered by Paolo Scanu, he is well-known designer from Italy.

Well-known makers for all systems and equipments.

Ethically sourced real teak decking provided for all exterior decks.

Suitable and comfortable guests cabins for chartering.

4.4m tender boat with Yanmar diesel engine.

Comprehensive NAVCOM equipments.

CCTV System consists of 12 cameras with IR.

Pop-up exterior lights

Underwater lights.

LED lighting for minimizing environmental impact.

Custom-made mahogany steering wheels.

The yacht is fully insulated to achieve fire protection, temperature, and humidity control, as well as noise and vibration dampening.

## Accommodation, Interior And Exterior Description

---

The magnificent deckhouse saloon offers a refined space for formal dining and lounging, boasting spectacular sea views and meeting the expectations of modern living.

### **ACCOMMODATION:**

The Yacht is designed and outfitted to accommodate 12 guests and 7 crew.

**Master Cabin:** Offering luxurious accommodations with all details.

- Totally 30sqm located at aft side.
- King size bed and 2-seaters
- Sea views from both sides.
- Seperate wearing room
- Functional writing table
- Large bathroom

**Guests Cabins:** This vessel features two double guest cabins (13m<sup>2</sup>), each with a private closet and bathroom. Additionally, three twin guest cabins provide a separate shower.

The arrangement of the guest accommodation was tailored to offer clean, relaxed geometry within the spaces, whilst ensuring generous stowage and en-suites. Soft edges and geometry in the furniture, with generous handrails in transition spaces, feed into the comfort of the guests.

**Crew Area and Accommodation:** Crew accommodations are thoughtfully designed with the captain's cabin and three double crew cabins located at forward side, complete with private bathrooms and separate showers. A fully equipped galley, crew mess and dry storage.

**Main Salon/Dining:** It is 48sqm ; seamless access to the main salon is provided by electric sliding doors on both the port and starboard sides of the aft deck. The spacious main salon invites to relaxation with U-shaped sofas, coffee tables, and bar area. A formal dining area features an U-shaped sofa for 8 guests and dining table for 10 guests, and bar area for 3-seats.

**Galley:** The double-L-shaped galley is clean, contemporary, and fitted out with the best appliances. The design has also allowed for substantial extra freezer space forward.

### **The yacht's interior features:**

Luxury and comfortable cabins  
Moisture resistant treated hardwoods.  
High quality marine insulated plywoods w/MED Certified  
Waterproof adhesives.  
Veneer with UV-resistant finishes and coatings.  
Advanced vibration and sound solutions.  
Honeycombed strength substructures.  
Flame-retardant upholstery and soft furnishings.  
Genuine leather headboards from Marine Leather in Italy.  
Decorative wall sconces.  
Luxury lighting solutions from BCM and Cantalupi Lighting.  
Automatic Curtains and Blinds.

### **EXTERIOR DECKS:**

The exterior joinery keeps the roots of tradition embedded with mahogany elements alongside luxurious exterior upholstery.

Main deck offers shade and magnificent vistas with a retractable sun awning while an exclusive private aft deck lounge serves for perfect sunset parties.





**Aft Deck:** The aft deck offers a luxurious outdoor oasis and featuring large sunbeds. Aft, a convertible dining table accommodates up to 16 guests, complemented by a I-shaped lounge sofa perfect for 6 guests and 2x 1 seat. A fully equipped wet bar station with entertainment system.

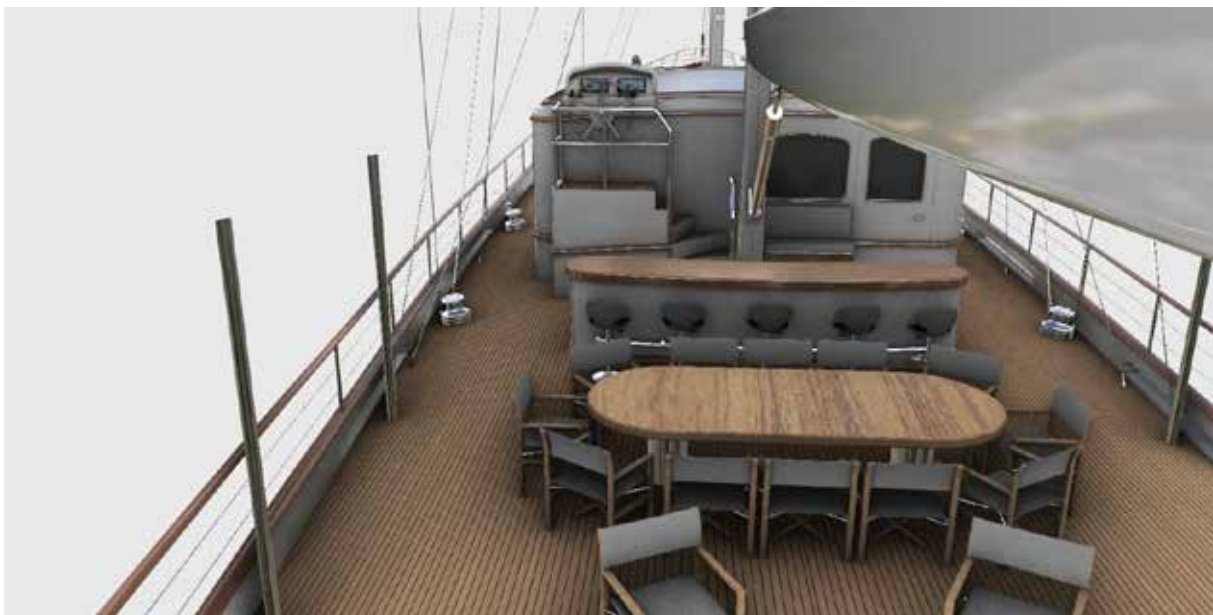





**Fore Deck:** On the foredeck, a sofa and coffee table create another inviting lounge area in front of the wheelhouse. Completing the amenities, a crane facilitates launching the tender boat and jetskies from the foredeck. The resulting foredeck space is vast and could lend itself as a shaded-chillout area during the day and dance floor by night.





## Machinery

---

MAIN ENGINES 2x MAN Marine Diesel Engines 441kW@ 2100RPM)  
REDUCTION GEARBOX 2x ZF W350-1), i:3.026  
PROPELLER 2x 4-bladed  
GENERATOR 2x KOHLER 55 Kw  
BOW THRUSTER SIDE POWER SH1000 Tunnel type

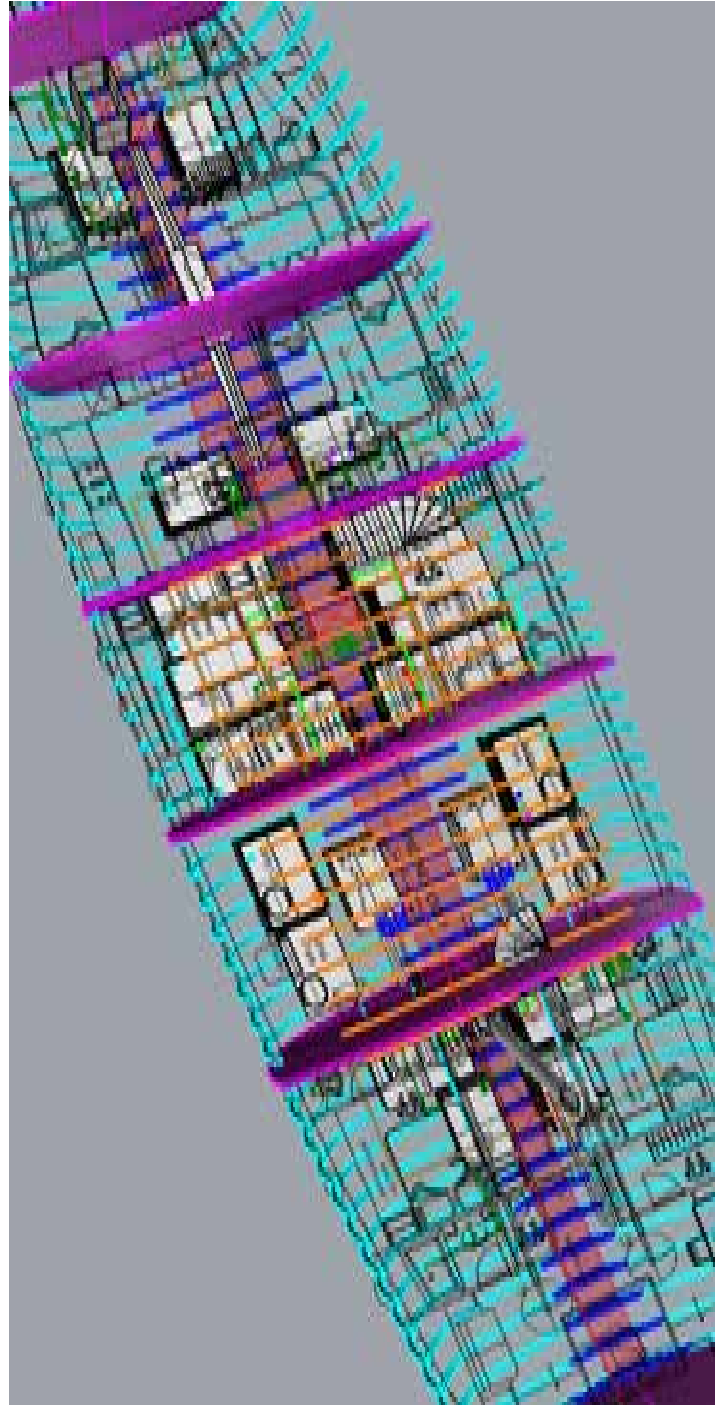

## **Auxiliary & Ancillary Equipment**

ELECTRICITY: 400/230V AC 50Hz 24V DC 3P+N Schneider or eq.  
BATTERIES & CHARGERS: VICTRON AGM & GEL Batteries for starters, service and emergency use.  
LIGHTING: BCM, CANTALUPI, FORESTI SUARDI LED Downlights, rope lights, courtesy lights, reading lights or equivalent  
UNDERWATER LIGHT: UNDW.LIGHTS 16x Warm White  
BILGE & FIRE PUMP: 2x GIANNESCHI ACM501 BT  
WATER MAKER AQUAPRIME 1x Dual 400  
PUMPS GIANNECSHI Systems' pumps  
COMPRESSOR ATLASCOPCO 2x G3P-10, 22 M3/H, 10 Bar  
VENTILATOR&EXTRACT: EBM-PAPST W6D630GN01-01  
SEWAGE TREATMENT ECOMAR 45 S  
WC SYSTEM JETS Vacuum or TECMA  
GENERATOR WATER GAS SEPERATOR, Centek Gen-Sep DN100 x2  
CHILLER UNIT: VECO CLIMMA  
PASARELLA: EZBERCI HYDRAULIC  
WT DOORS: BOFOR  
GALLEY EQUIPMETS: VITRIFRIGO. DOMETIC, MIELE



## **Rigging & Sails**

---

The whole sailing systems of the yacht including rigging, mast, sails, captive winches, mooring winches, deck hardware, deck switches, bobstay, and all related items will be supplied by the Shipyard.

### **SAILS**

MAIN SAIL (260m<sup>2</sup>)  
MIZZEN SAIL (191m<sup>2</sup>)  
GENOA (371m<sup>2</sup>)  
STAY SAIL (118m<sup>2</sup>)  
TOTAL SAIL AREA 896m<sup>2</sup>  
GENNAKER 850m<sup>2</sup>

### **DECK EQUIPMENT**

ANCHOR WINDLASSES 2x DATA DZC3300 Hydraulic  
ANCHORS AND CHAIN CUSTOM 2x 160kg HHP  
CHAIN STOPPER 2x DATA DZS17-20  
1x Tender boat APRX. 4.4m Length  
DECK CRANE EZBERCI MARINE 1x 500KG telescopic  
PASARELLA 1x EZBERCI MARINE  
BOARDING LADDER 1x EZBERCI MARINE side ladder  
Owner Supply (2x 3man jetski)  
DAVIT and GANGWAY EZBERCI MARINE  
ALL SAIL WINCHES by HARKEN  
WEATHERTIGHT DOORS 3x BOFOR @WH Port and WH STB and Saloon Ent.  
WATERTIGHT DOORS 1x BOFOR @ER entrance  
HATCHES BOFOR Stainless Steel 316L, watertight  
STEERING WHEELS: Custom-made  
LED Underwater lights to minimize environmental impact.



## Navigation & Communication Equipment

All of navigation and communication equipments will be completed according to flag and loyd regulations for under 500GRT and GMDSS A3.

X-BAND RADAR SYSTEM  
DOME RADAR  
ECDIS  
QUICK INTEGRATED SYSTEM  
GPS NAVIGATOR  
AUTO PILOT  
GPS COMPASS  
MAGNETIC COMPASS  
ECHO SOUNDER  
DOPPLER SPEED LOG  
AIS Class A & GPS Antenna  
GMDSS A3 AREA COMMUNICATION SYSTEM  
MISC NAUTICAL EQUIPMENTS  
SP TELEPHONE  
WEATHER STATION  
EPIRB  
SART



